



# **CALCULATE ASPECT RATIO ROAD HAZARD**

## **VAST Enterprise Retail**

*The material in this document is applicable for ALL VAST Enterprise Retail versions and for ALL VAST Enterprise Multi-Store versions.*

**TABLE OF CONTENTS**

**INTRODUCTION.....3**

**BASIC CONCEPTS.....3**

**1. VAST MAINTENANCE.....4**

    A. ACCOUNT CODES .....4

    B. MASTER TABLE .....5

    C. TAG ALONG PARTS.....7

    D. CONTROLS .....8

**2. VAST POINT OF SALE.....10**

## INTRODUCTION

This document will provide you with instructions on how to setup and use **Road Hazard Warranties**. There is more than one way to utilize Road Hazard Warranties in VAST, they are:

- **Calculating Road Hazard Warranties** Use the **ASPECT RATIO** of your tires to determine price calculations on your **Road Hazard Warranties**, as well as specifying whether the Road Hazard Warranty should only be applied to **Passenger and Light Truck Tires** or **All Tires**. This feature allows you to **Select** an **ASPECT RATIO** as a **CUTOFF**, and then specify **three** different **percentages** to be used to calculate road Hazard Charges. The calculation will **Multiply** the **Sell Price** of the tire by the **Road Hazard Warranty Percentage** you enter for **Tires** that have an **Aspect Ratio BELOW** the number you select as a **CUTOFF**, for **Tires** that have an **Aspect Ratio AT** the number you select as the **CUTOFF**, and for **Tires** that have an **Aspect Ratio HIGHER** than the number you select as the **CUTOFF**. For instructions on how to use this new functionality, please follow the steps listed below.

## BASIC CONCEPTS

- Road Hazard Warranty **without** the Aspect Ratio calculates from the tire Master List Price, but the Road Hazard Warranty **with** the Aspect Ratio calculates from the tire Sale Price.
- Road Hazard Warranty calculation is performed when it is put on the estimate, not when the tire part is put on the estimate.
- The **highest** Road Hazard Warranty calculation is used when there are multiple tire parts on the estimate.
- All Road Hazard Warranty parts on the estimate are updated with the tire quantity and the highest calculated price or the List Price, which ever is higher.
- If the **Tire Size – Ratio** is **not** entered on the Master, the Road Hazard Warranty price will be its Master List Price

## 1. VAST MAINTENANCE

### A. ACCOUNT CODES

1. First, you will need to setup account codes that contain tire parts to calculate Road Hazard Warranties. To do this, go to **ACCOUNT CODES** from the **VAST MAINTENANCE MENU**.
2. Select the account codes that your **TIRE PARTS** are assigned to and click on the general information tab, as shown below.

3. Put a checkmark in the **ROAD HAZARD WARR.** checkbox.
4. Click **SAVE**, then click **DONE**.

**\*NOTE\*** - You will need to complete these steps for **ALL ACCOUNT CODES** that contain **TIRES** in order to allow the **Calculation of ROAD HAZARD WARRANTIES**.

## B. MASTER TABLE

1. To setup one or more **ROAD HAZARD WARRANTY PARTS** on your Master Table open VAST Maintenance and go to **MASTER TABLE**.
2. Click on the **ADD NEW** button at the bottom of the screen.
3. You will be taken to the **PART INFO** screen. Enter all of the information for the **ROAD HAZARD WARRANTY PART**.

**\*NOTE\*** - The **LIST PRICE** you enter here will be the **DEFAULT MINIMUM AMOUNT** to charge the customer for Road Hazard Warranties. If the calculated Road Hazard Warranty Price is **LESS THAN THIS AMOUNT**, VAST will use the **LIST PRICE** as the **SELLING PRICE** for the Road Hazard Warranty part.

**Master File RHW 100% ROAD HAZARD WARRANTY**

Part Grid	Part Info	Alt Parts	Tires	Other Info.
Part Number	RHW	MFG Code	ABDG	
Account Code	99001	Comp Part Number	RHW	
Item Desc	100% ROAD HAZARD WARR.	Core Value	.00	
Buyers Desc	100% ROAD HAZARD WARRANTY	Package Qty	1	
Published Cost	.00	Nat Pop Code		
Part Cost	.00	Cycle Days	0	
List Price	8.00	Business ID		
Labor Price	.00	NIA Code		
Part Add On	.00	Labor Payable Hours: Min./Max.	0 / 0	
Labor Add On	.00	Work Hours	0	
MSRP List	.00	Auto Location		
		Invoice Order		
<input type="checkbox"/> Package Part	<input checked="" type="checkbox"/> Discountable	<input checked="" type="checkbox"/> Taxable	Other Tax: ---	<input type="checkbox"/> Bendable
<input checked="" type="checkbox"/> Special Part	<input type="checkbox"/> Order Even Qty	<input type="checkbox"/> Inventoryable		<input type="checkbox"/> Royalty Part (see AcctCd)
<input type="checkbox"/> Disabled	<input type="checkbox"/> Allow Decimal Quantity			

Buttons: Delete, Add New, Cancel, Save, Done

**\*NOTE\*** - The data in the screenshot above is **INFORMATIONAL ONLY**. You can use any **Part Number, Account Code, Manufacturer and Price Info** you wish, however, make sure you do **NOT** select an account code that contains **TIRE PARTS**.

4. Bring up a tire part and go to the **TIRES** tab.

Master File 51166 1856515BFG TOUR TA HR4 86H

Part Grid	Part Info	Alt Parts	Tires	Other Info.
<input checked="" type="checkbox"/> Tire Part ?				
Load Rating	86	Speed Rating:	H	
Tire Walls		UTQG:		
Tire Type		M and S Rated:	<input type="checkbox"/>	
P/LT	P	Severe Snow Rated:	<input type="checkbox"/>	
Warranty		Manufacturer's Warranty Miles:	0	
Search Size	1856515	Non-Manufacturer's Warranty Miles:	0	
Catalog Size	1856515	Legacy GL Reference:		
Tire Tread	10 / 32nds	Legacy Part Reference:		
Orig. Tire Tread	10 / 32nds	Tire Rim Size (Diameter):	.00	
Load Range/Ply		Tire Size - Width:	185	
Material #		Tire Size - Ratio:	65	
		Tire Size - Wheel:	15	

5. Enter the **Aspect Ratio** and **Passenger** or **Light Truck Designation** for **ALL** of your tires.
  - Enter the **TIRE'S ASPECT RATIO** into the **TIRE SIZE- RATIO** field.
  - If the tire is a Passenger or Light Truck Tire, enter a **"P"** for **PASSENGER** or **"L"** for **LIGHT TRUCK** in the **P/LT** field, as shown below. If the tire is **NOT** a Passenger or Light Truck Tire, leave this field **BLANK**.
6. Click **SAVE** and then click **DONE** to exit the screen.

**\*NOTE\*** - You will need to **COMPLETE STEPS 5-6** for **ALL** of your tire parts in order to **CALCULATE** Road Hazard Warranties based on the **ASPECT RATIO** and have the option to base **ROAD HAZARDS** on Passenger and Light Truck tires.

## C. TAG ALONG PARTS

1. You may choose to assign your road hazard warranty part as a **TAG-ALONG**. To do this, go to **TAG ALONG PARTS** from the VAST Maintenance Menu.
2. Select a Method by clicking on the radio button next to the **METHOD** you would like to use to build the Tag-A-Long. In most cases you will want to select **PARTS** or **DESCRIPTIONS** attached to a part that is a tag-a-long to the Tire part. This is because on the Tire Look up screen in Vast, the Road Hazard Warranty calculation is only done if it is a second level tag-a-long to the Tire part.

**\*NOTE\*** - As an alternative, you could use **PARTS** or **DESCRIPTIONS** attached to **CLASS**, as long as your Road Hazard Warranty part is **NOT** in the **SAME** Sales Class as your tire parts.

3. Click the **ADD NEW** button at the bottom of the screen.
4. On the new line that appears, type in either the **ACCOUNT CODE** or **SALES CLASS** that contains your tire parts, depending on which method you selected to use.
5. Hit **TAB** on the keyboard and type in the **ROAD HAZARD WARRANTY PART NUMBER** you built on the **Master**. The **TAGALONG DESCRIPTION** field will automatically be filled in for you.
6. Put a checkmark in the **QTY** checkbox. Your screen should now look similar to the one shown below.

**Part Replacements and Additions**

**Choose a Method:**

Parts or Descriptions Attached to Accountcode  
  Parts or Descriptions Attached to Part  
  Parts or Descriptions Attached to Bang Part  
  Parts or Descriptions Attached to Class

Spawning Account Code	Tag Along Part Number	Tagalong Description	QTY	Disabled
481	TAX		<input checked="" type="checkbox"/>	<input type="checkbox"/>
96047	RRB	REMOVE / REPLACE BATTERY	<input type="checkbox"/>	<input type="checkbox"/>
96159	OA	OXYGEN / ACETYLENE	<input type="checkbox"/>	<input type="checkbox"/>
99001	RHW	100% ROAD HAZARD WARRANT	<input checked="" type="checkbox"/>	<input type="checkbox"/>

Tag Along Parts for Tires Will Go Only One Level Deep

**\*NOTE\*** - If you used the **ACCOUNT CODE** Method, you will need to complete **STEPS 3-6** for **ALL** tire account codes that you want to have **CALCULATE** Road Hazard Warranties.

7. When you are **FINISHED** entering the information, click **DONE** to **EXIT** the screen.

## D. CONTROLS

1. Next, you will need to set up the **ROAD HAZARD WARRANTY PERCENTAGES**. To do this, open VAST Maintenance and go to **CONTROLS**.
2. Click on the **FEES/ROAD HAZARD WARRANTIES** tab. You will see a screen similar to the one shown below.

**Control File**

General Point of Sale System Parameters  
 Wholesale Options Claim Interface  
 Additional Parts/Catalogs Average Cost  
 Operating System Reporting Misc  
 Accounts Payable General Ledger Outside Purchase  
 \*Fees/Road Hazard Warranties Purchases Accounts Receivable

Percent: 5.00  
 Cap Amount: 10.00  
 Min. Amount: 2.00

Include Fee on:  Parts  
 Labor

Fee By Class

Print on bottom of Invoice:   
 Printed Part number :  
 Shop Supply

\*Don't forget to create a new Part in the Master called FEE

Enforce Tire Fees:

Road Hazard Warranties  
 R = Aspect Ratio. To use the Aspect Ratio formula for calculating the price for the Road Hazard Warranty: Enter the Ratio Cutoff, then in the Part row set the Standard % to zero, check 'Use R%'s', fill in the %'s for '<=' and '>', the ratio cutoff, and check 'Only P/LT' if the Road Hazard part should only be added to the estimate/workorder only for Passenger or Light Truck tires.

rc=Aspect Ratio Cutoff: 50

RH Part Nbr	Std %	Use R%'s	%R<=rc	%R>rc	Only P/LT
RHW	0.00	<input checked="" type="checkbox"/>	21	10	<input checked="" type="checkbox"/>
		<input type="checkbox"/>	0		<input type="checkbox"/>
		<input type="checkbox"/>			<input type="checkbox"/>
		<input type="checkbox"/>			<input type="checkbox"/>

RH Warranty price -  
 Rounding Cutoff: .21  
 (zero = no rounding)

To delete a Part, blank out the Part Number

Company 1050

Cancel Done

3. On this screen, there is a description of the **ASPECT RATIO FORMULA** in **BLUE TEXT**, which briefly explains the setup process. The first item you will need to fill in is the **RC=ASPECT RATIO CUTOFF** field. Enter a number in this field.
4. Click in the **RH PART NBR** field and enter the **ROAD HAZARD WARRANTY PART NUMBER** that you setup in the **MASTER FILE**.
5. Click or hit the tab key to go to the **STD%** field. **ENTER** a **ZERO** in this field.
6. Click to put a checkmark in the **USE R%'s** checkbox.
7. Click in the **%R<=rc** field. Enter a number for the Percentage you would like to use to calculate road hazard warranties on tires that have an **ASPECT RATIO LESS THAN** or **EQUAL TO** the Aspect Ratio Cutoff number specified.

8. Click in the **%R>rc** field. Enter a number for the Percentage you would like to use to calculate road hazard warranties on tires that have an **ASPECT RATIO GREATER THAN** the Aspect Ratio Cutoff number.
9. Place a checkmark in the **ONLY P/LT** field if you want VAST to **Add** the Road Hazard Warranty part to the Estimate. This occurs **ONLY** for the Road Hazard Warranties on tires that you have designated as **PASSENGER** or **LIGHT TRUCK** tires.
10. Enter a number in the **RH WARRANTY PRICE – ROUNDING CUTOFF** field if you would like vast to
  - Automatically Round the calculated road hazard warranty price on the estimate to the **CLOSEST FULL DOLLAR AMOUNT**.
  - The **CENTS** value must be entered in the following format **'0.01'**.
  - If the **CENTS** value of the calculated price is **LESS THAN OR EQUAL TO** the amount you specify here, it will be *rounded down* to the dollar amount with **ZERO CENTS**.
  - If the **CENTS** value is **GREATER THAN** the amount you specify, the price will be *rounded up* to the **NEXT FULL DOLLAR AMOUNT**.
  - If you do **NOT** want to use the rounding feature, please put a **ZERO** in this field.
11. Click **DONE** to save your changes. You will receive the following message:

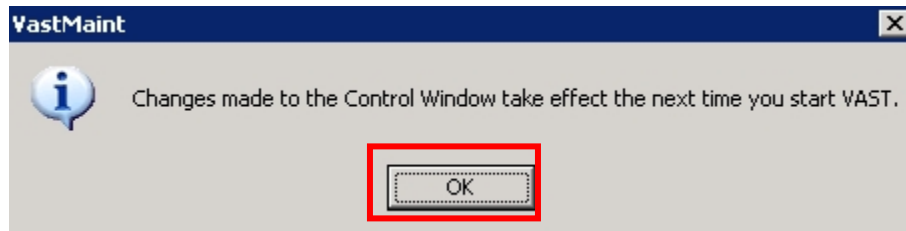

12. Click **OK** and you will be taken back to the **MAINTENANCE MENU**.
13. To see how this feature can be used, open **VAST POINT OF SALE** and either create a **NEW ESTIMATE** or **OPEN** an **EXISTING ESTIMATE**.

## 2. VAST POINT OF SALE

1. On the Parts Entry screen, enter a tire part number or use the tire search size feature to select a tire.
2. When the tire is put onto the line, if you have the Road Hazard Warranty part set up as a tag-a-long you will see that the Road Hazard Warranty part you have set up will be **AUTOMATICALLY ADDED** to the estimate and the **SELL PRICE** will be calculated according to what is setup in the **CONTROL FILE**, as shown below.

**Aftersoft Networks NA VAST Version 7.0.336 DB Version 10.0.0**  
**0003 - AFS Auto & Tire, Inc.**  
 Computer: TERMSERV

**2002 TOYOTA SIENNA**      **BETH HARTMAN**      **Workorder #167**

All	Job	Total Parts	Total Labor	Discount	Total Sale	GM
	PASSENGER TIRES	\$155.24	\$0.00	0.00	\$155.24	
	MISC AUTO SERVICE	\$14.00	\$0.00	0.00	\$14.00	
	SHOP SUPPLIES	\$0.70	\$0.00	0.00	\$0.70	

<b>Parts</b>	<b>\$169.94</b>
<b>Labor</b>	<b>\$0.00</b>
<b>Discount</b>	<b>\$0.00</b>
	<b>\$169.94</b>
<b>Tax</b>	<b>\$8.50</b>
<b>Total:</b>	<b>\$178.44</b>

Service comments   Technicians   Disposal   Work Order Status   Wholesale Tire  
 Authorizations   Car Info   Declines History   Tire Sizes   Estimate Profile

Part Number	Loc	RFR	Description	Qty	Sell Price	Labor	OH	Additional Info
FEE		0	Shop Supply Charge	1	0.70	0.00	0	ABDG
51166			1856515BFG TOUR TA HR4 86H	1	155.24	0.00	0	1856515
RHW			100% ROAD HAZARD WARRANTY	1	14.00	0.00	0	ABDG
*								

Delete   Package   Discount   Totals   Catalog   Customer   UnDecline  
 Decline   Old Warr.   Inventory   Specs   Alternate   Print   Exit